

APPROX. SCALE: 63%

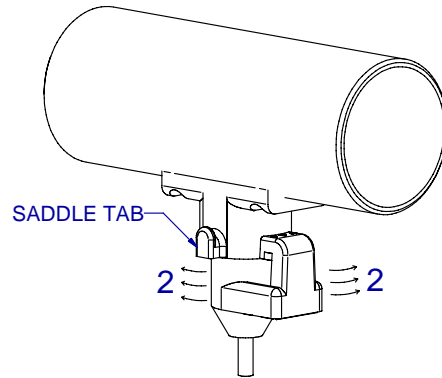

APPROX. SCALE: 63%

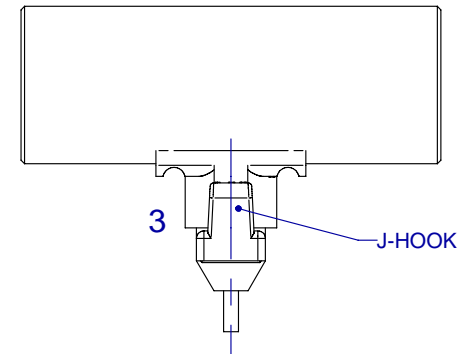

APPROX. SCALE: 63%

ACTIVE DRINKER INSTALLATION

- 1.) USING YOUR FINGERS ONLY, BRING THE AKTIVE DRINKER INTO POSITION WITH THE O-RING TOUCHING EVENLY ALL THE WAY AROUND THE SADDLE. (ILLUSTRATION NR. 1)
- 2.) ROTATE THE DRINKER LEFT AND RIGHT WHILE AT THE SAME TIME EXERTING EVEN PRESSURE TO SNAP THE DRINKER J-LOCK OVER THE SADDLE TAB. MAKE CERTAIN THAT THE TAB AND J-HOOK ARE CENTERED. (ILLUSTRATION NR. 2)
- 3.) ROTATE DRINKER TOWARDS THE SADDLE TAB. EXERT SUFFICIENT PRESSURE TO SNAP THE DRINKER J-LOCK OVER THE SADDLE TAB. MAKE CERTAIN THAT THE TAB AND J-HOOK ARE CENTERED. (ILLUSTRATION NR. 3)
- 4.) DO NOT TRY TO FORCE THE DRINKER INTO THE SADDLE WITH TILTED FORCE. THIS MAY CAUSE THE O-RING TO COME OUT OF IT'S SLOTTED POSITION AND WATER WILL LEAK AROUND THE O-RING (ILLUSTRATION NR. 4)
- 5.) DO NOT USE DRINKER TOOL (PART NR. 956) FOR STEPS 1 & 2 ABOVE. USE OF DRINKER TOOL FOR STEP 3 IS PERMITTED.
- 6.) IF AN INDIVIDUAL AKTIVE DRINKER IS HARDER THAN NORMAL TO INSTALL INTO THE SADDLE, CHANCES ARE THE O-RING HAS COME OUT OF ITS SLOTTED POSITION. REMOVE DRINKER FULLY FROM THE DRINKER SADDLE, REPOSITION THE O-RING INTO ITS SLOT AND REINSTALL WITH MORE CARE.

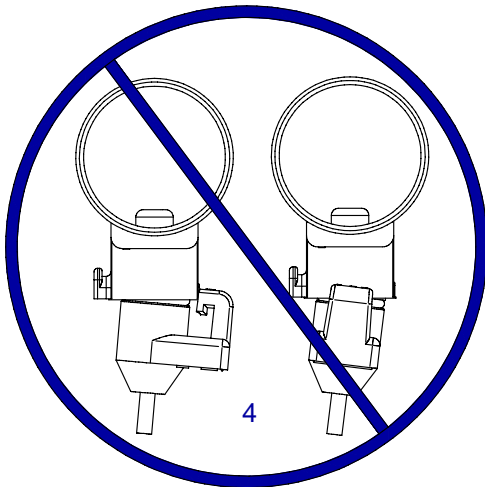

APPROX. SCALE: 63%

ACTIVE DRINKER REMOVAL

- 1.) UNSNAP THE AKTIVE DRINKER FROM THE SADDLE TAB. (DRINKER TOOL MAY BE USED FOR THIS STEP).
- 2.) GRIP THE AKTIVE DRINKER WITH YOUR FINGERS AND ROTATE BACK AND FORTH WHILE SIMULATANEOUSLY EXERTING DOWNWARD PRESSURE.
- 3.) DO NOT TILT THE DRINKER WHILE REMOVING (NOTE ILLUSTRATION 4).
- 4.) DO NOT USE TOOLS, SUCH AS PLIERS, TO REMOVE THE DRINKERS. DOING SO WILL DAMAGE THE DRINKERS AND CAUSE THEM TO MALFUNCTION.